

MARSHSIDE

NOWELL CREEK VILLAGE



Developed, Leased and Managed
by Holder Properties
holderproperties.com

For Leasing Inquiries

Billy Cooke : 843.608.1745
Friend Gray : 843.409.0888
marshsidechs.com

Marshside at Nowell Creek Village
100 Coastal Drive
Charleston, SC 29492





Welcome to Marshside at Nowell Creek Village.

Nestled between the marshes of Nowell and Beresford Creek, Marshside is a 200,000 SF 'Class A' office building within Nowell Creek Village, a new waterfront community on Charleston's Daniel Island. The reimagined and renovated building features contemporary office spaces and thoughtful amenities that foster and support our tenants' community and social connection.

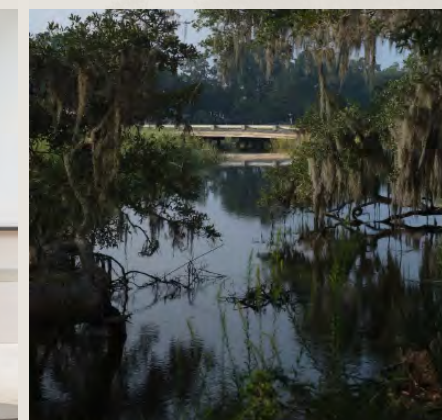



Multi-Use Atrium

The multi-use lobby is filled with natural light





 **AMPLE NATURAL LIGHT**

 **BIKE ROOM**

 **FITNESS STUDIO,
SHOWERS & LOCKERS**

 **MARSH VIEW**

 **MULTI-USE
ATRIUM**



Service Features

Concierge Service
On-Site Property Management

Building Features

Energy Efficient Systems
New Restrooms + Common Areas

Site Features

Ample Surface Parking
Community Dock





9'0" WINDOW HEIGHT

VERTICAL ACCESS
6 ELEVATORS TOTAL

FLOOR PLATE AREA 55,000 SF / PER LEVEL
LARGE, EASILY CONFIGURABLE FLOOR PLATE AREA

READY TO MOVE IN SUITES

CONCIERGE DESK

MARKET

CONFERENCE FACILITY

MULTI-USE ATRIUM

GAME ROOM



Service Features

Concierge Service
On-Site Property Management

Building Features

Energy Efficient Systems
New Restrooms + Common Areas

Site Features

Ample Surface Parking
Community Dock



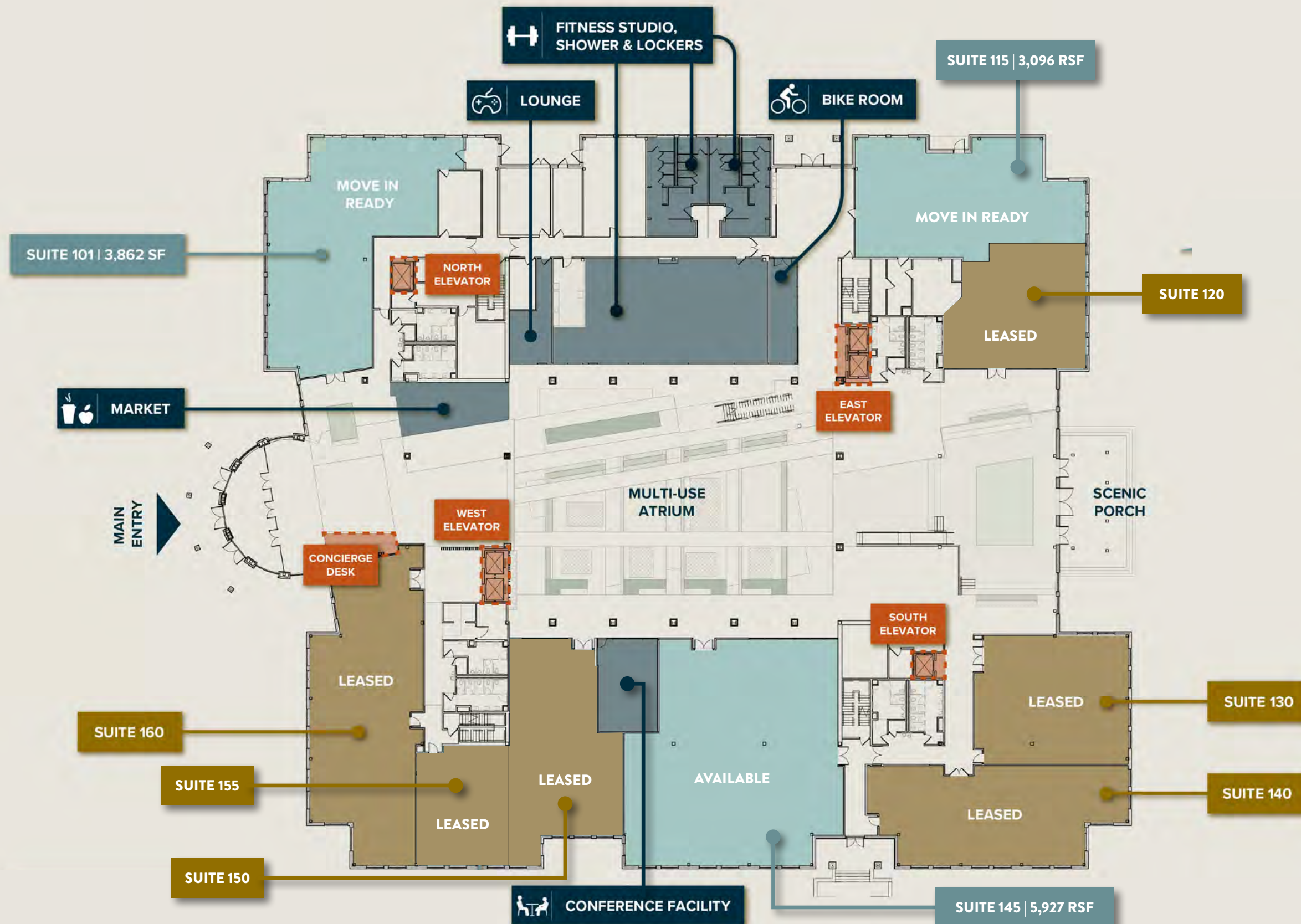

Ground Level Leasing Plan

Amenities, Elevators,
and Suite Boundaries





Second Level Leasing Plan

Elevators and
Suite Boundaries





Third Level Leasing Plan

Elevators and
Suite Boundaries





Fourth Level Leasing Plan

Elevators and
Suite Boundaries





Nowell Creek Village





Park | Retail | Residential | Office



Charleston Area Map

Points of Interest,
Major Roadways,
Transportation Hubs

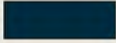
LEGEND

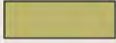
-  Roadway Marker
-  Roadways
-  Location Marker
-  Transportation
-  Park Space





Aerial Site View

Connected to the Heart of Daniel Island and Greater Charleston

FOOD & BEVERAGE

- 1 New Realm Brewery
- 2 Agaves Cantina
- 3 Mpishi Restaurant
- 4 Sermet's Courtyard
- 5 Vespa Pizza
- 6 Wasabi of Daniel Island
- 7 Beech
- 8 The Kingstide
- 9 Laura Alberts
- 10 Viva Taco & Tequila
- 11 Blondies Bagels & Café
- 12 The Dime

HOTELS

- 13 Home2 Suites
- 14 Hampton Inn Daniel Island



Daniel Island Area Map

Points of Interest, Parks & Rec,
Trails, and Roadways

LEGEND

-  Roadway Marker
-  Roadways
-  Location Marker
-  Transportation
-  Park Space

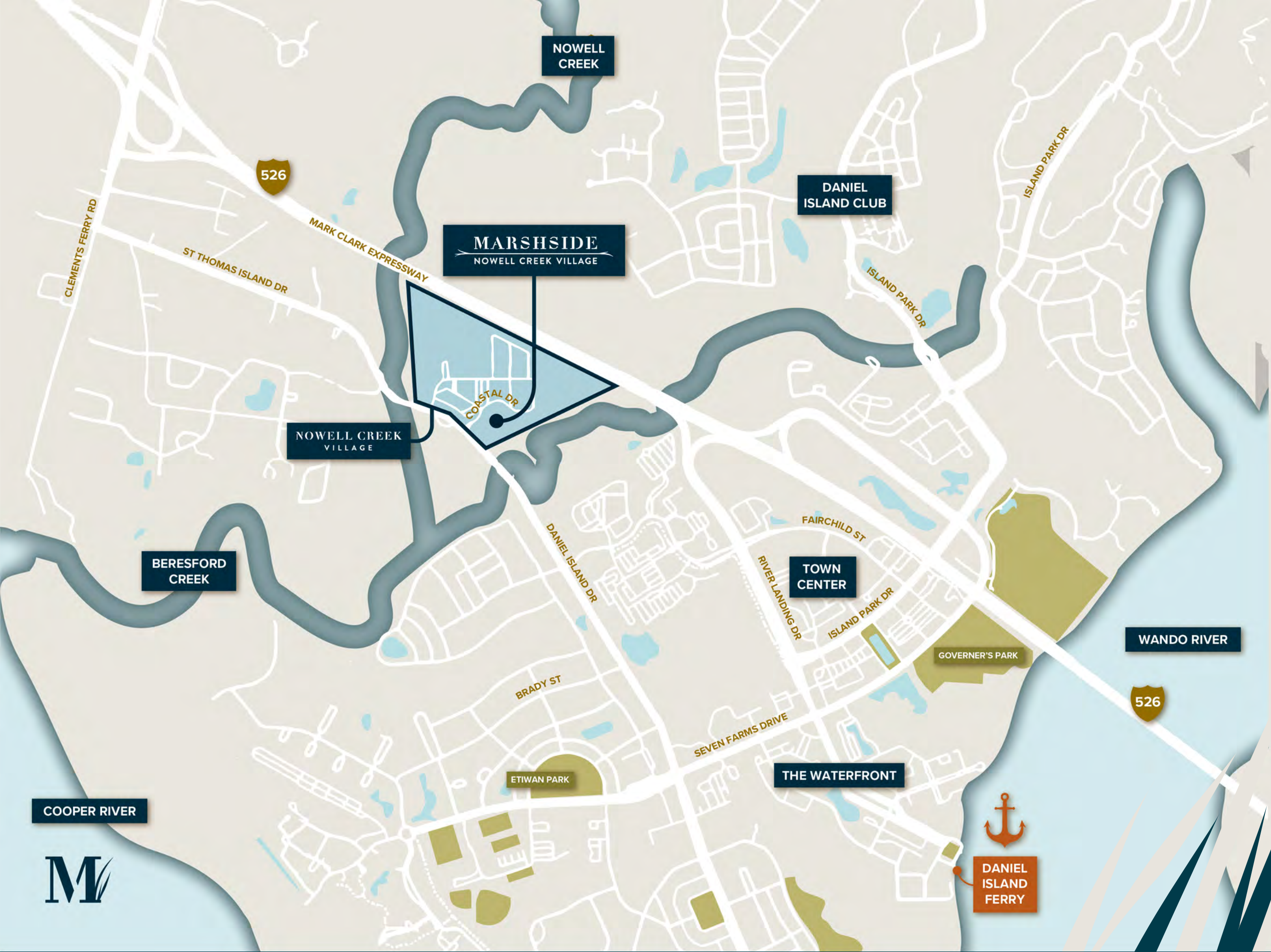

MARSHSIDE

NOWELL CREEK VILLAGE



Developed, Leased and Managed
by Holder Properties
holderproperties.com

For Leasing Inquiries

Billy Cooke : 843.608.1745
Friend Gray : 843.409.0888
marshsidechs.com

Marshside at Nowell Creek Village
100 Coastal Drive
Charleston, SC 29492

